

LEANO 24 & 32 VANITIES

SLBA643; SLBA770

General Product Information

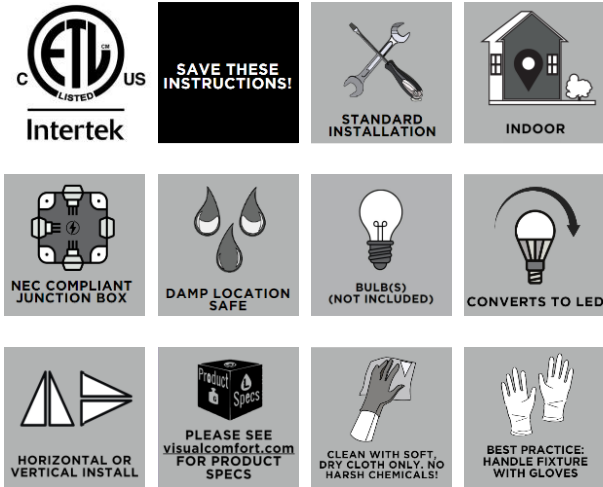

Tools Required/Suggested

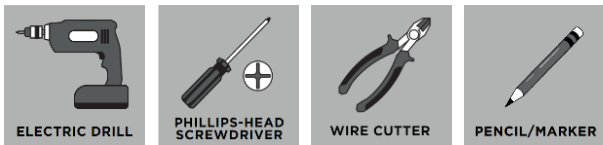

Safety Information

CAUTION-RISK OF FIRE

This product must be installed in accordance with the applicable installation code by a person familiar with the construction and operation of the product and the hazards involved.

USE MINIMUM 90°C SUPPLY CONDUCTORS.



Turn off electrical current at the source before working with any lighting fixture or portable lamp.

Install and use this product in adherence with local electrical codes and regulations.

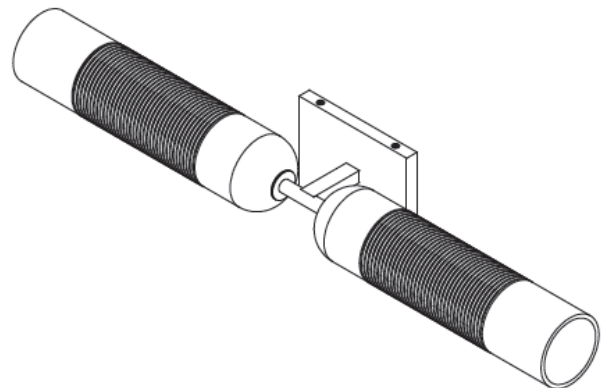
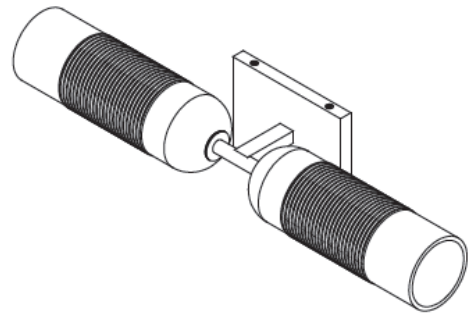

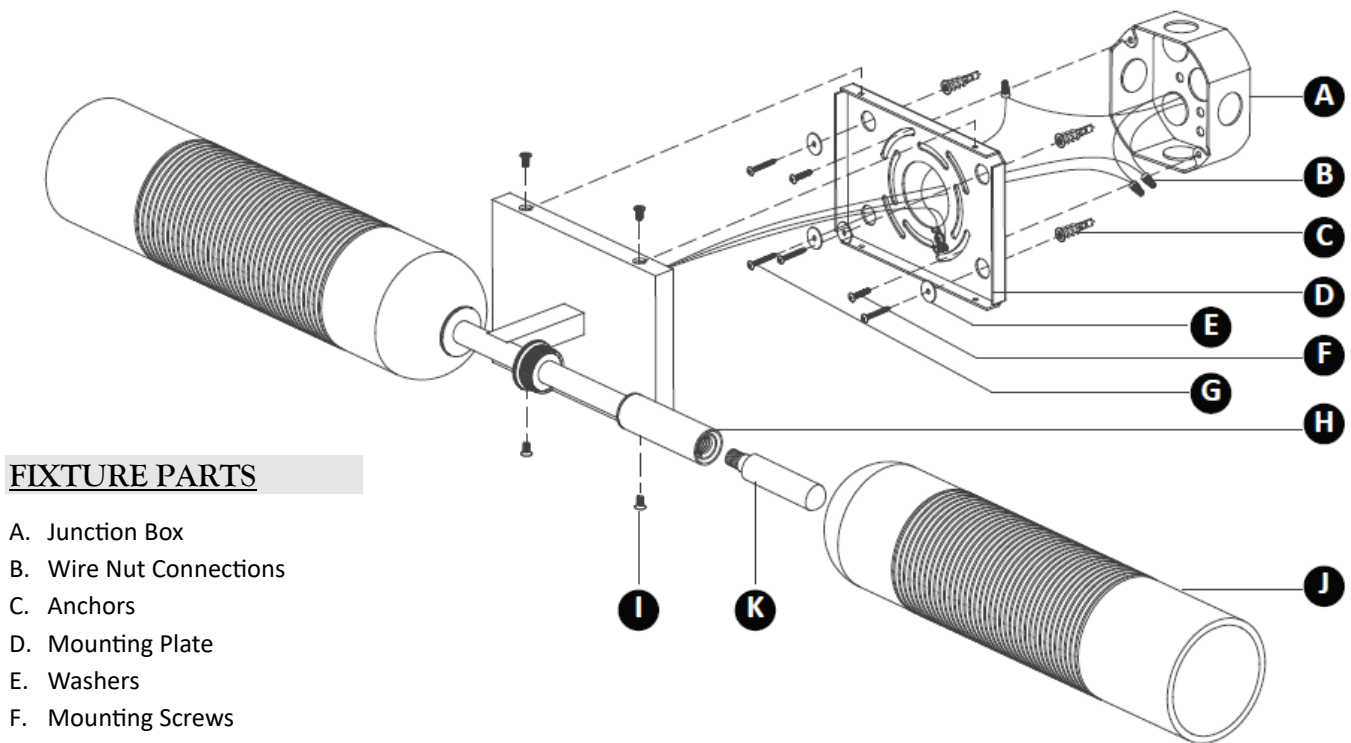

FIXTURE PARTS

- A. Junction Box
- B. Wire Nut Connections
- C. Anchors
- D. Mounting Plate
- E. Washers
- F. Mounting Screws
- G. Anchor Screws
- H. Sockets
- I. Fixture Screws
- J. Shades
- K. Light Bulbs (Not Included)

INSTRUCTIONS

I. Preparing the Fixture

1. Unbox and inspect all items included in the fixture's packaging. Place them on a clean, soft surface to prevent damage.
2. Unscrew the fixture screws to detach the mounting plate from the fixture backplate.
3. Hold the mounting plate against the junction box and mark the anchor hole positions. Drill holes at the marked spots using a drill bit slightly smaller than the provided anchors. Insert the anchors and screw them into place with a screwdriver.
4. Secure the mounting plate to the junction box using the provided mounting screws. Slide the washers onto the anchor screws, then drive the screws into the wall anchors to firmly attach the mounting plate.

II. Wiring the Fixture

1. Safety first! Locate the circuit breaker and switch it off to cut off the power supply to the relevant circuits to ensure there's no electricity running through the wiring.
2. In accordance with local electrical codes, connect the fixture ground wire (bare copper or silver wire) to a suitable ground. This may be a green ground screw on the mounting plate, which the ground wire should be tightly wrapped around, or a house wire (green or bare copper wire without insulation).
3. Twist the bare ends of the following pairs of wires together using a wire nut to secure a connection:
 - a. Hot fixture wire (black) and hot power line wire (usually black) from the junction box (hot to hot)
 - b. Neutral fixture wire (white) and neutral power line wire (usually white) from the junction box (neutral to neutral)
4. Carefully tuck all the wires behind the mounting plate into the junction box.

III. Installing the Fixture

1. Mount the fixture onto the installed mounting plate and secure it using the fixture screws.
2. Thread the shade onto the fixture to install it. DO NOT overtighten, as this may damage the glass.
3. Install the bulb (not included) into the socket to complete installation. Refer to the socket label for the maximum wattage rating.